

T8

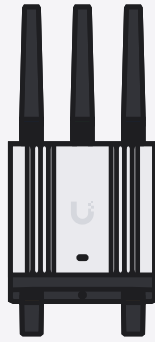

1



1x

a



1x

e

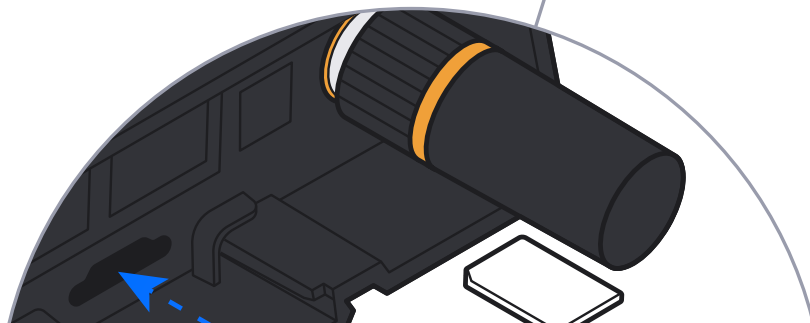
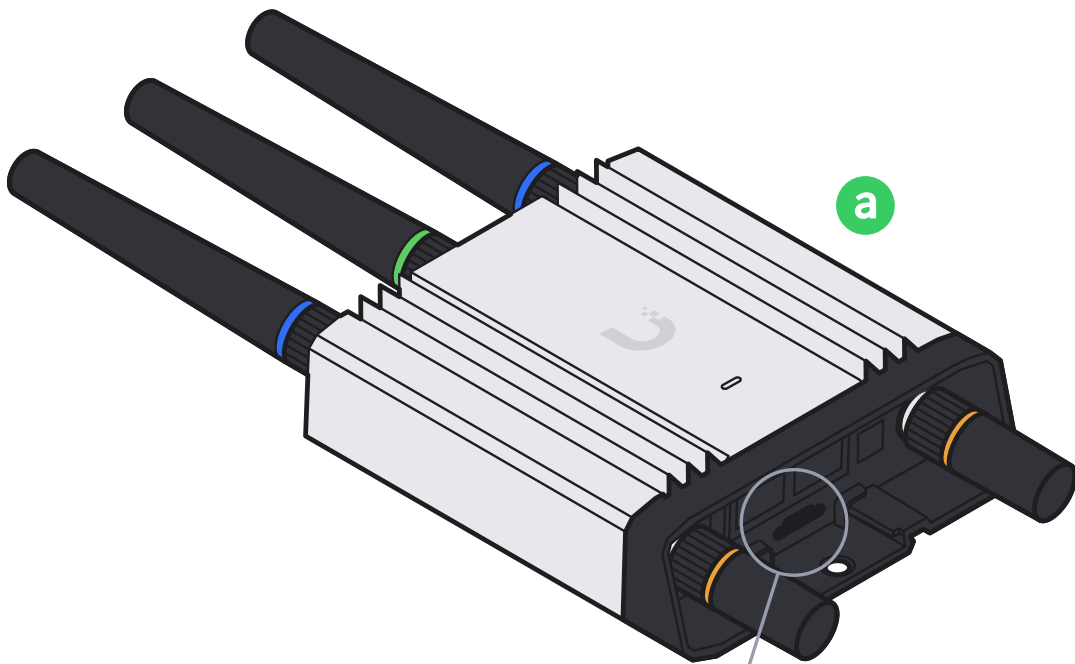

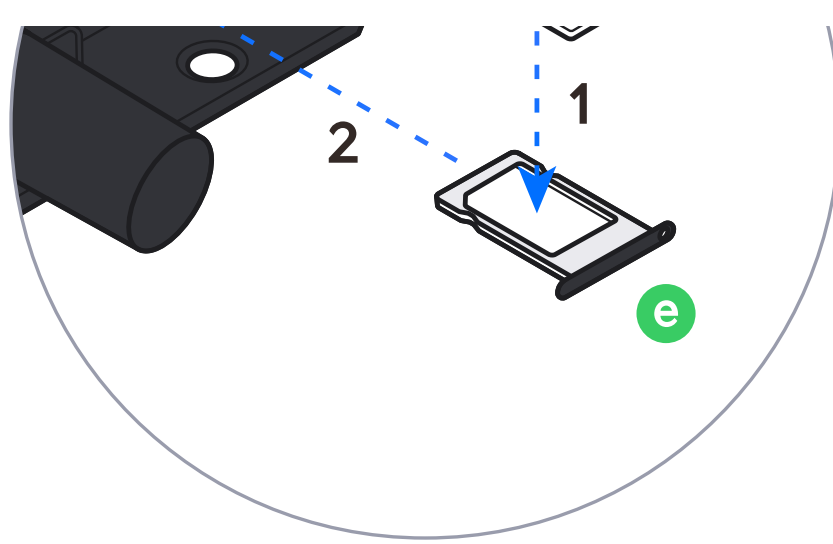

2



1x

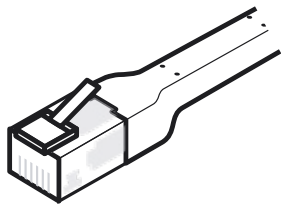

UniFi Patch Cable

[Buy >](#)

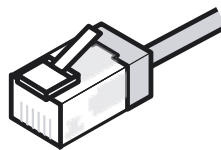

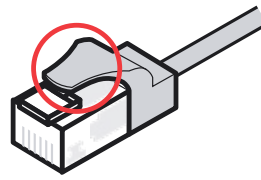
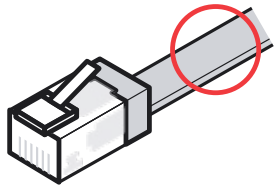

A

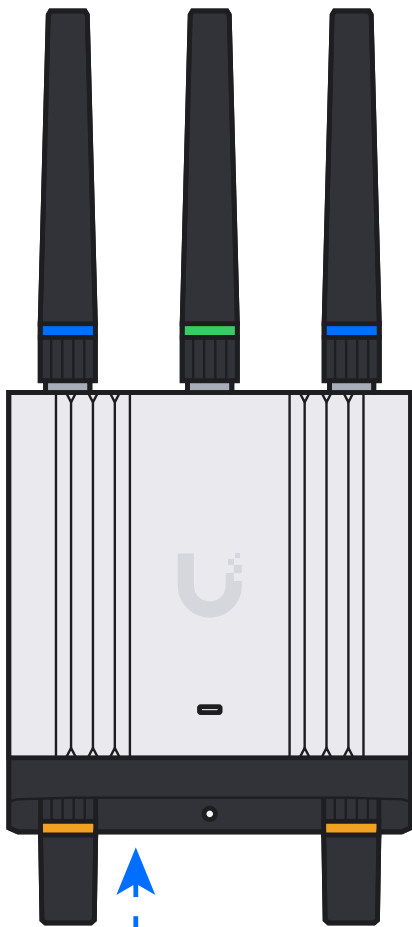

B

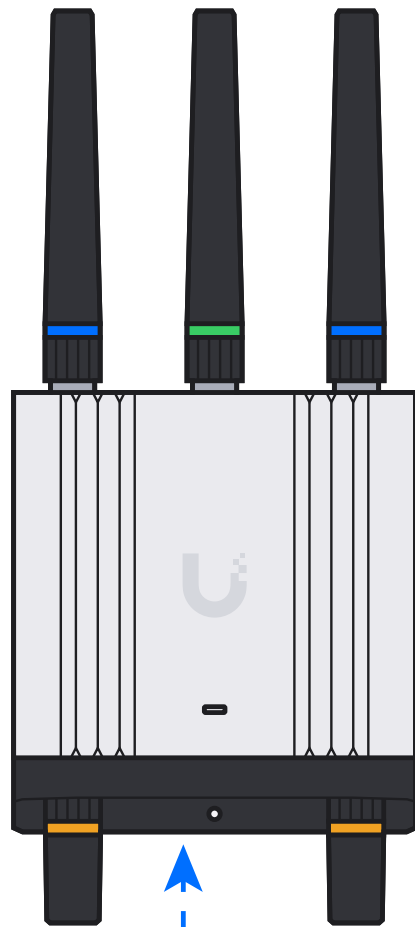



C

D

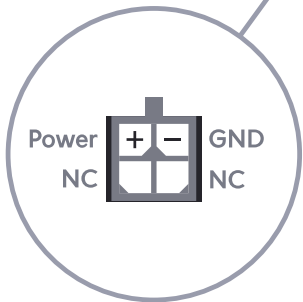
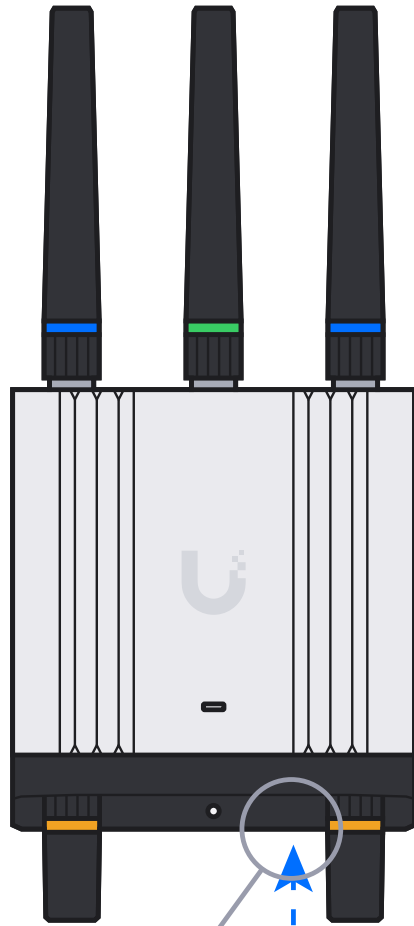
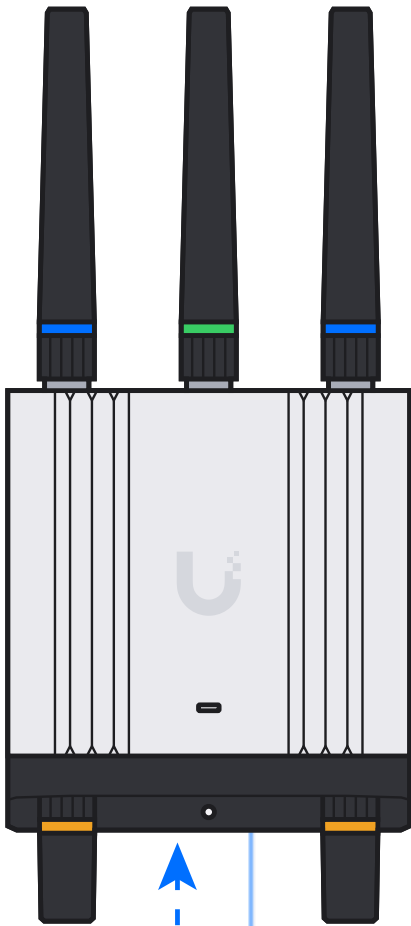

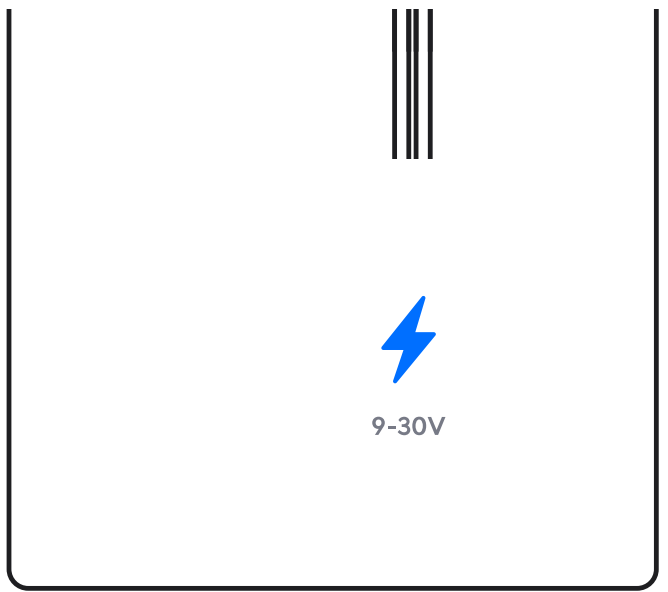
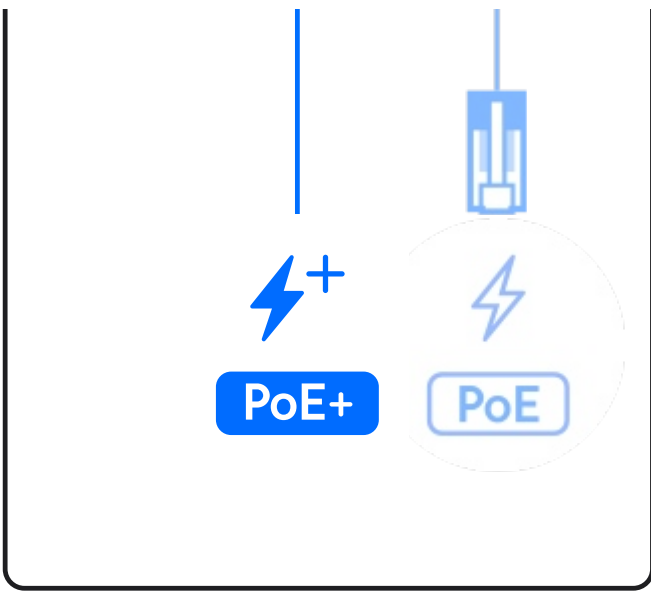

Power on and initialize (up to 2.5 min).

3

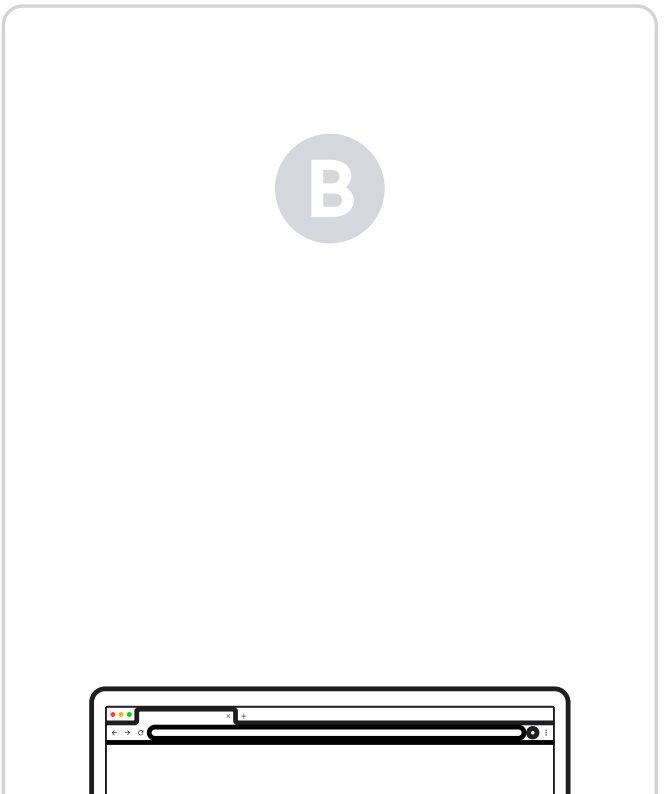
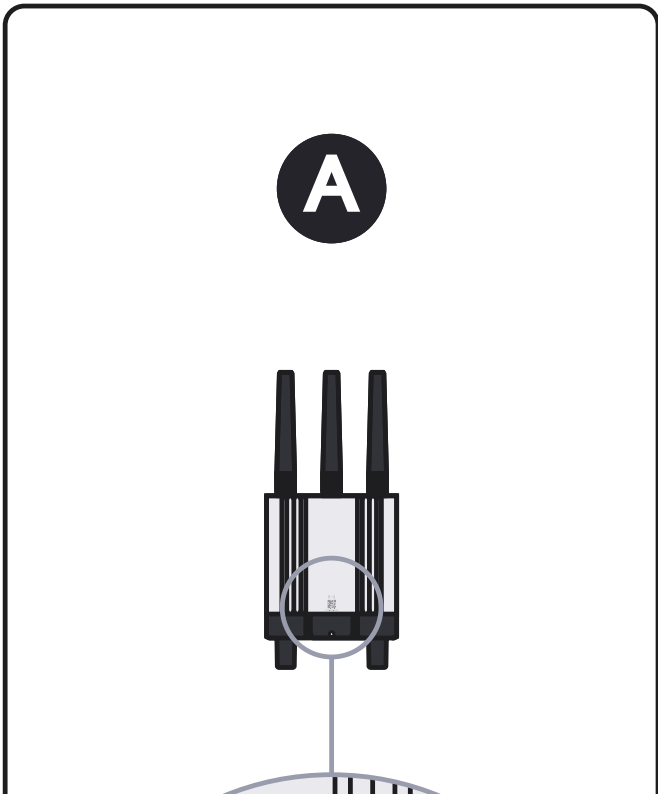

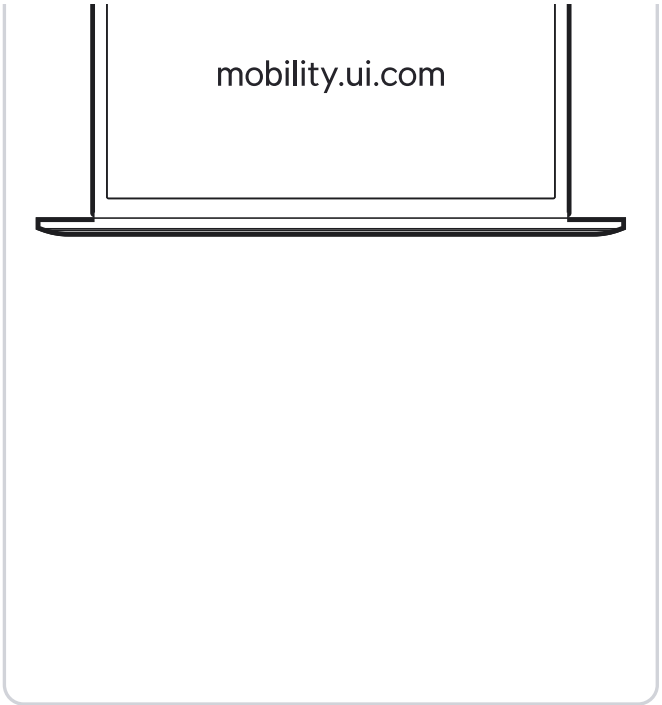
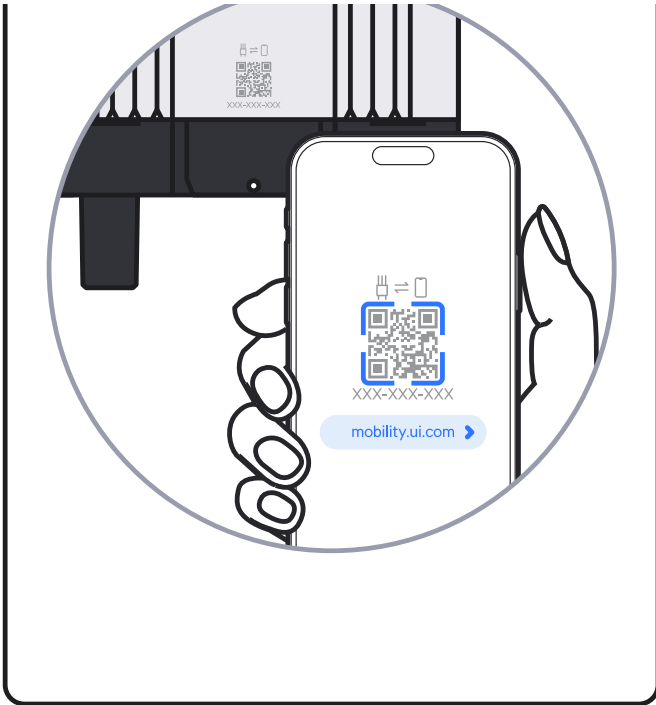

4



1x

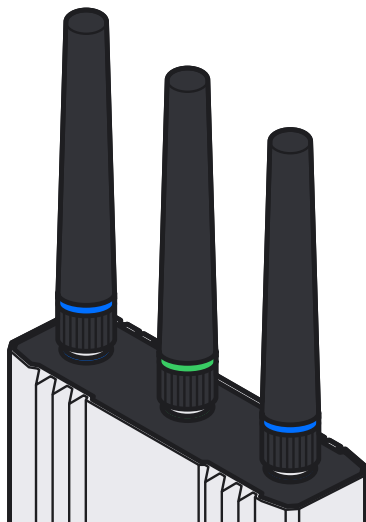

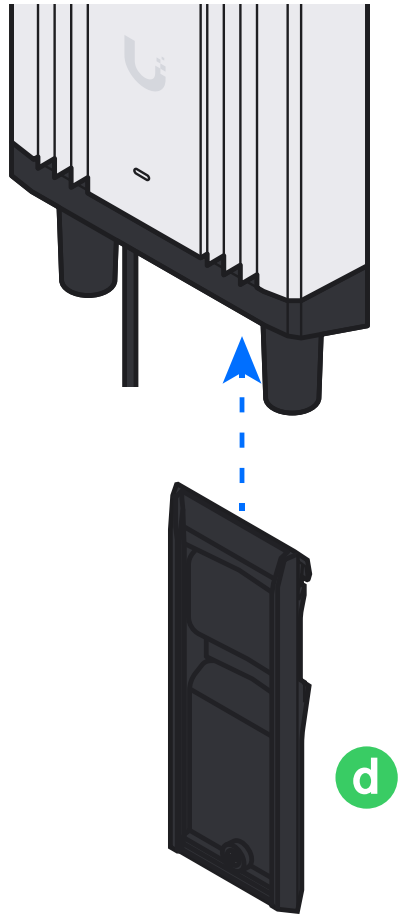

5

★
M2.5
1x
f



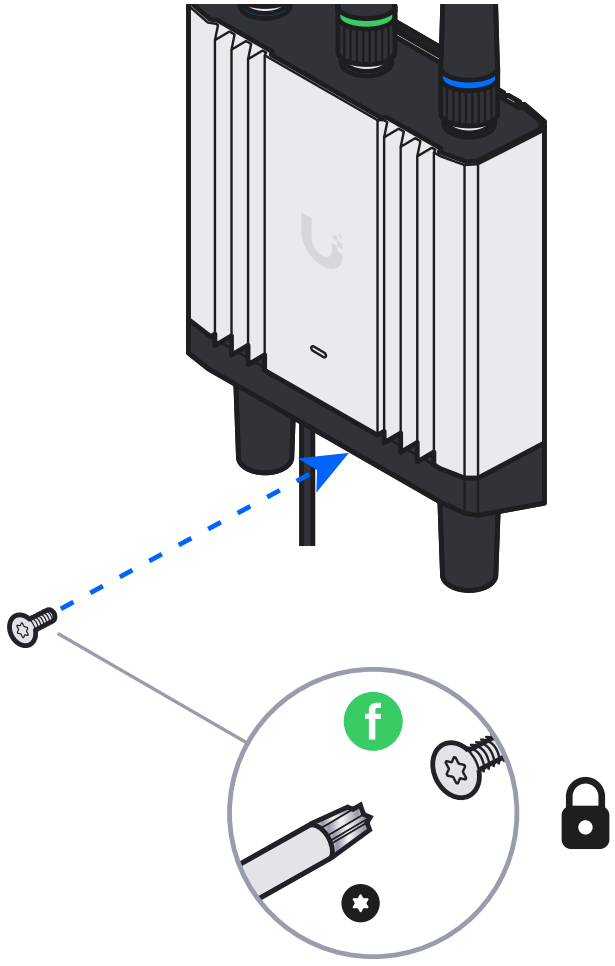



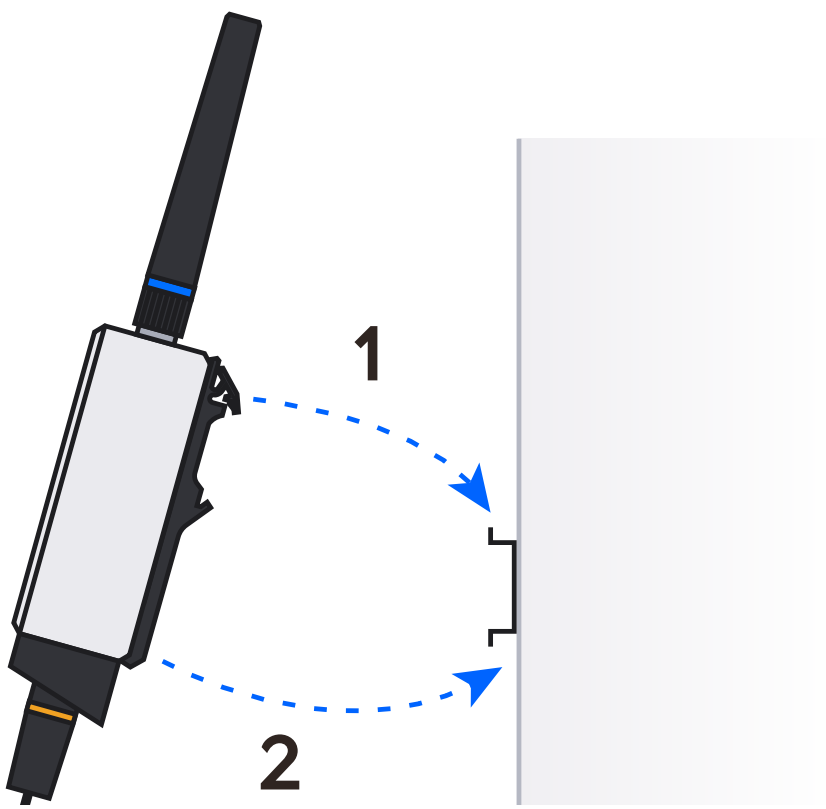

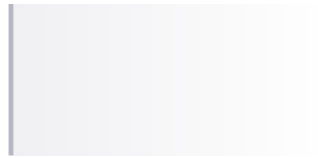
6



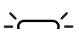

-  Steady White Device ready for setup.
-  Steady Blue Setup successful. Continue at mobility.ui.com.
-  Flashing White Unable to activate SIM. Check SIM PIN and APN.
-  Flashing Blue Unable to connect to the LTE network

Relocate the device or contact your ISP.

For more details please visit mobility.ui.com/doc/led.

8mm

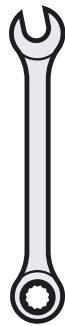

External WiFi Antenna
(RP-SMA Male Type)



1

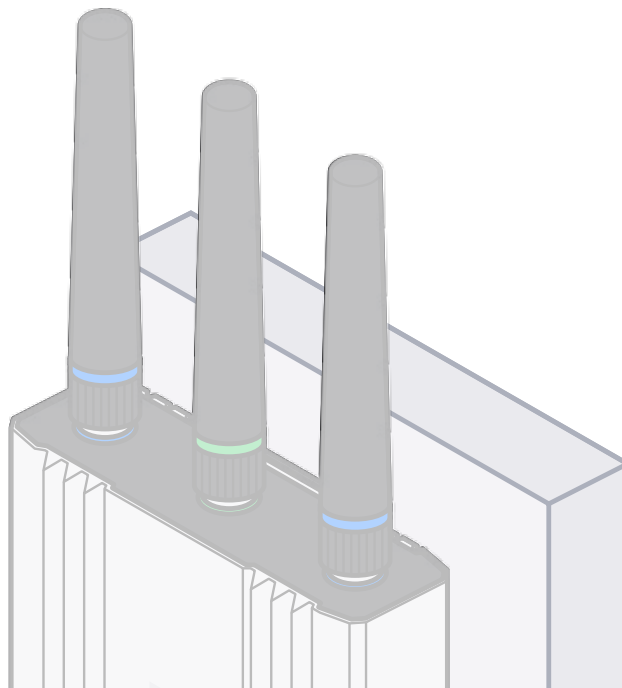

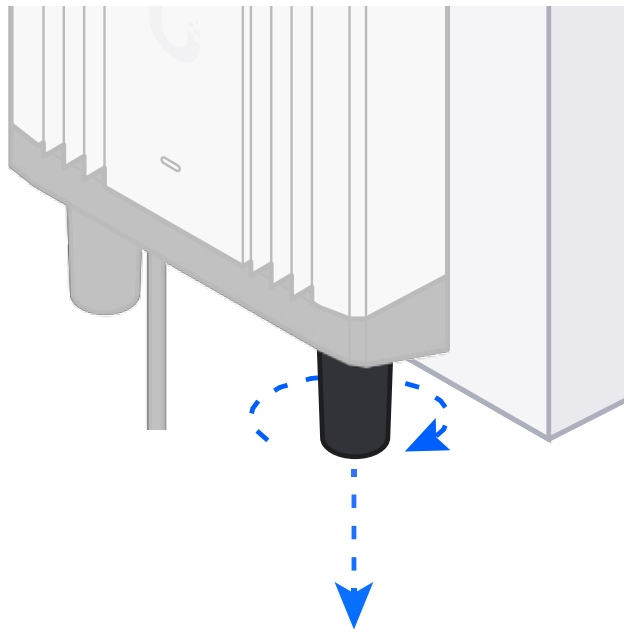

2

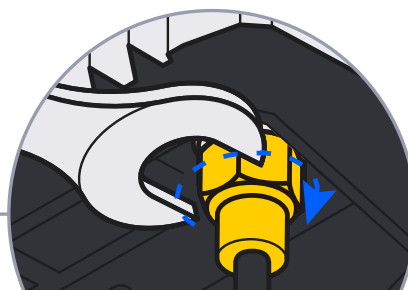
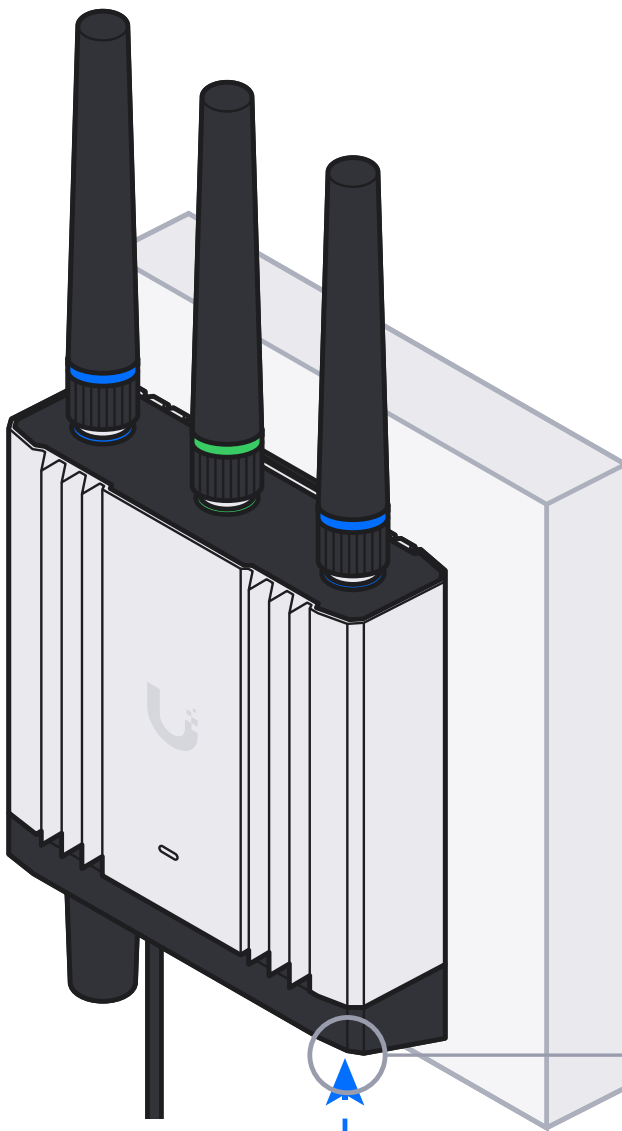

0.2 Nm



1x

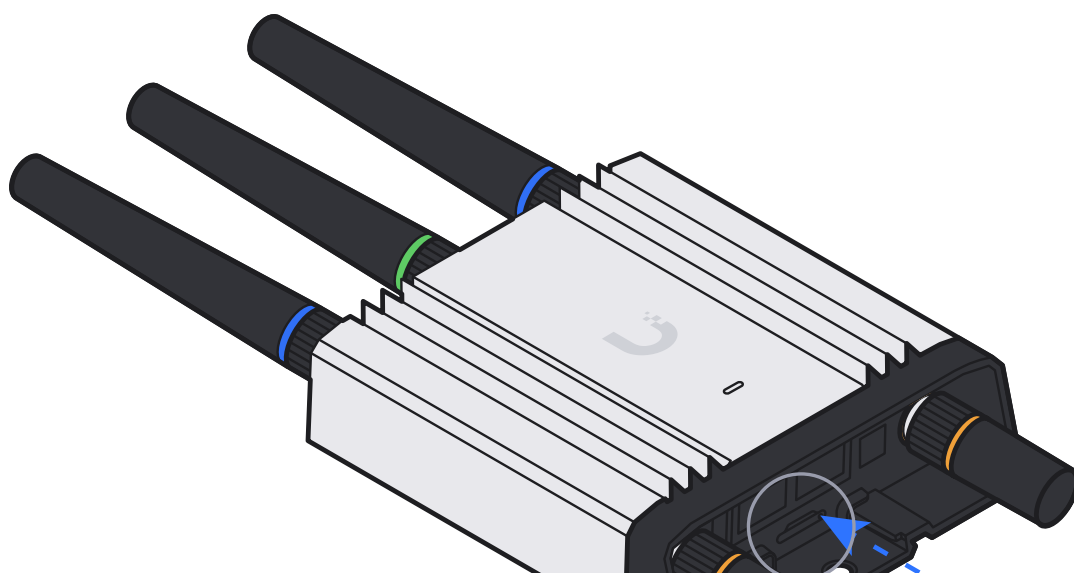

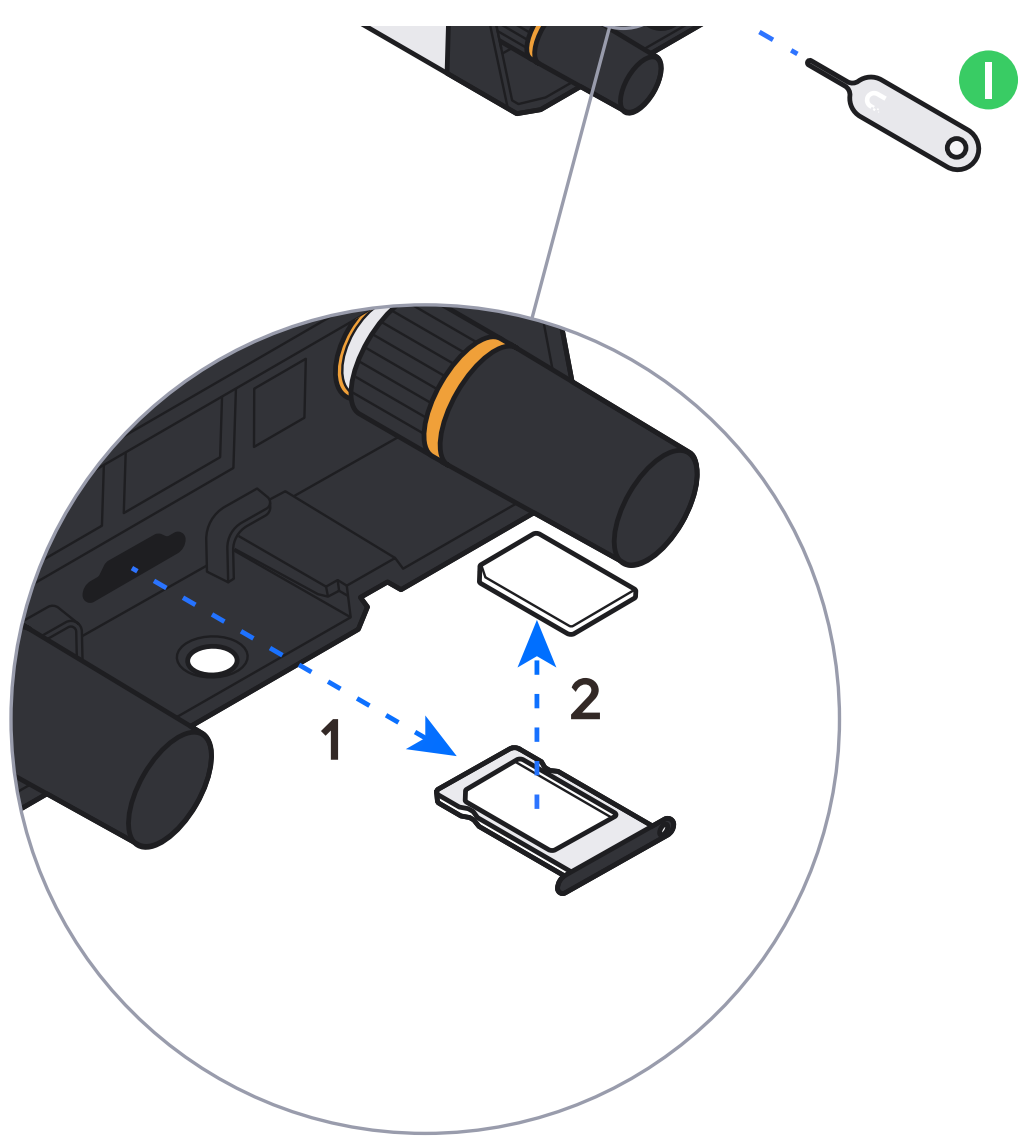

1x

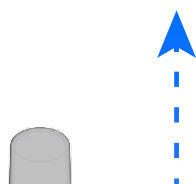

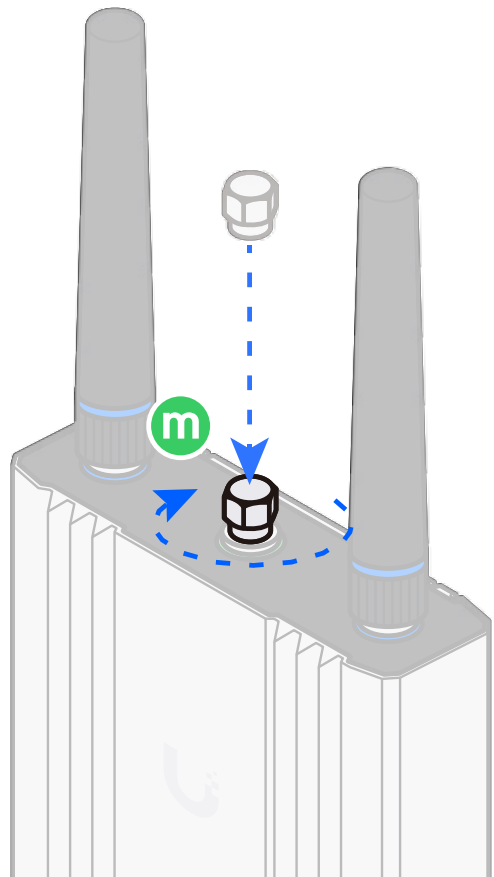
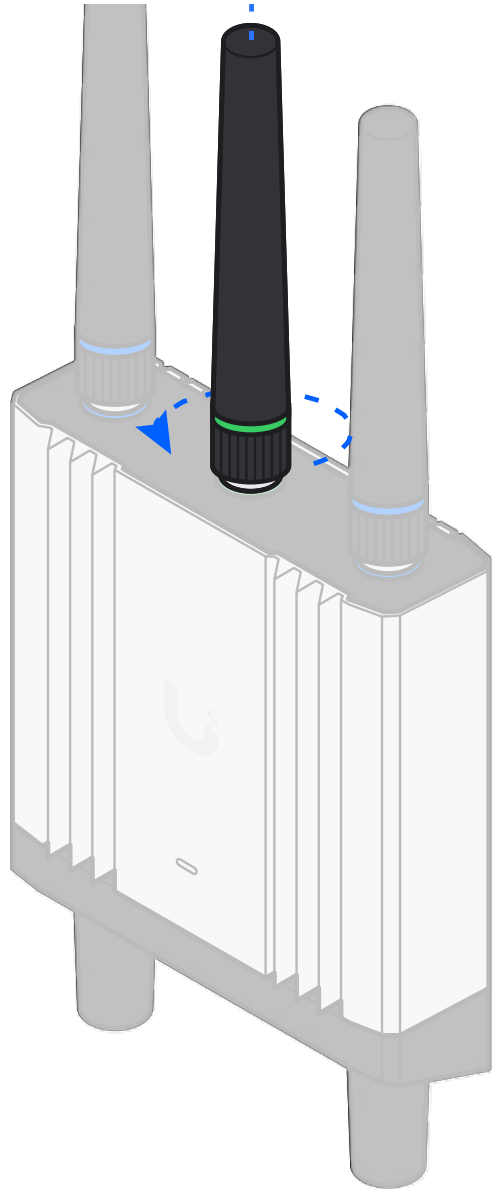

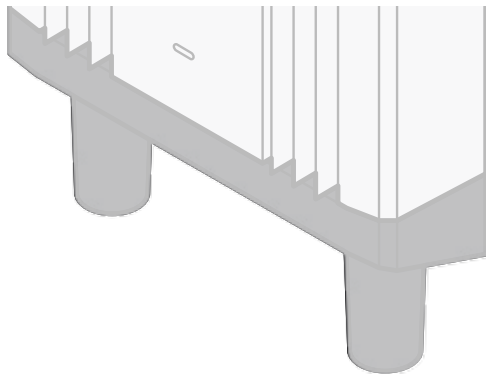

If you need further assistance, visit our [Help Center](#) or contact [Ubiquiti Support](#).